

Halolite Series

**M041-20W**

Reflector



Technical Parameters:

Name	Parameters
Light source:	COB
Input Voltage:	AC220~240V 50/60Hz
Current:	500mA
Rated life:	>50,000 hours
Operating temperature:	-20°C~40°C
Storage temperature:	-30°C~60°C
Certificate:	CE/RoHS
Dimmability:	Dimmable Optional
Weight:	0.3KG

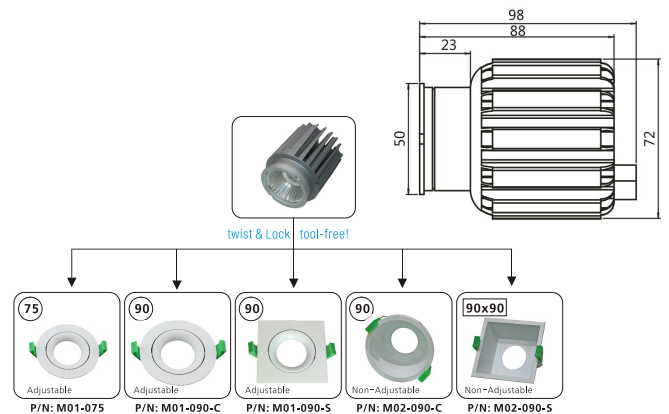

Ordering Information:

Power	CRI	Beam Angle	Luminous	CCT	Housing	Part Number
20W	>80	▲ 16°	2170 lm	3000K	○	M041*-20W-830-S-16
			2150 lm	4000K	○	M041*-20W-840-S-16
		▲ 28°	2110 lm	3000K	○	M041*-20W-830-S-28
			2110 lm	4000K	○	M041*-20W-840-S-28
		▲ 40°	2140 lm	3000K	○	M041*-20W-830-S-40
			2140 lm	4000K	○	M041*-20W-840-S-40
	>90	▲ 16°	2140 lm	3000K	○	M041*-20W-830-S-60
			2135 lm	4000K	○	M041*-20W-840-S-60
		▲ 28°	1770 lm	3000K	○	M041*-20W-930-S-16
			1970 lm	4000K	○	M041*-20W-940-S-16
		▲ 40°	1740 lm	3000K	○	M041*-20W-930-S-28
			1930 lm	4000K	○	M041*-20W-940-S-28
▲ 60°	1750 lm	3000K	○	M041*-20W-930-S-40		
	1960 lm	4000K	○	M041*-20W-940-S-40		
▲ 90°	1755 lm	3000K	○	M041*-20W-930-S-60		
	1955 lm	4000K	○	M041*-20W-940-S-60		

○ Silver gray

\*\*": 1: S-MR16; 2: M01-075; 3: M01-090-C; 4: M01-090-S; 5: M02-090-C; 6: M02-090-S

Technical Data test pattern

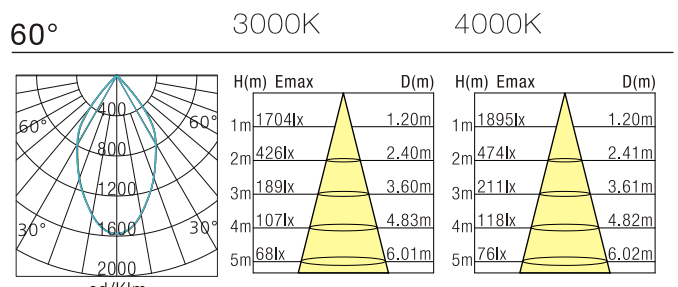
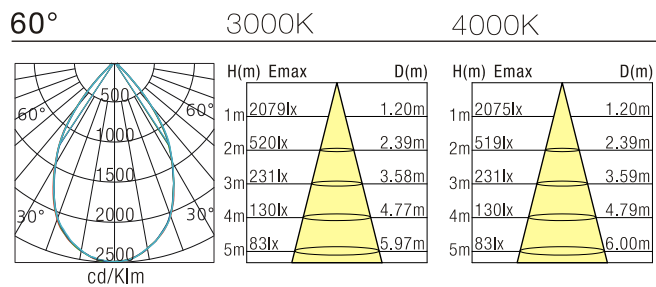
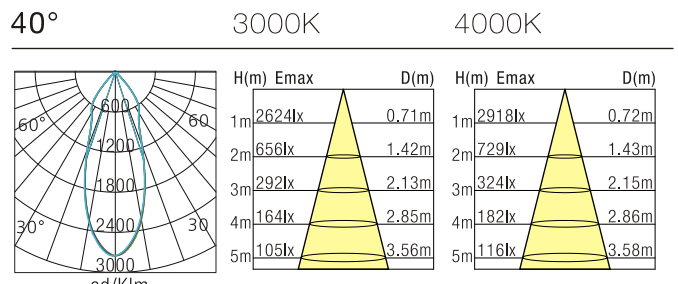
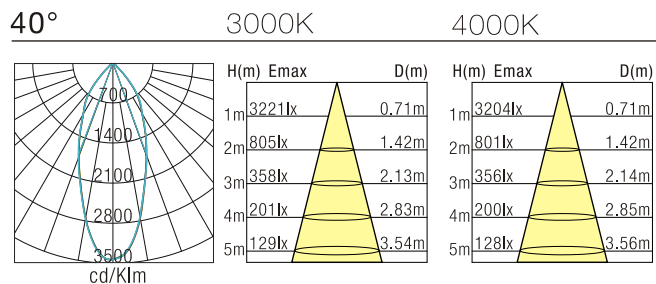
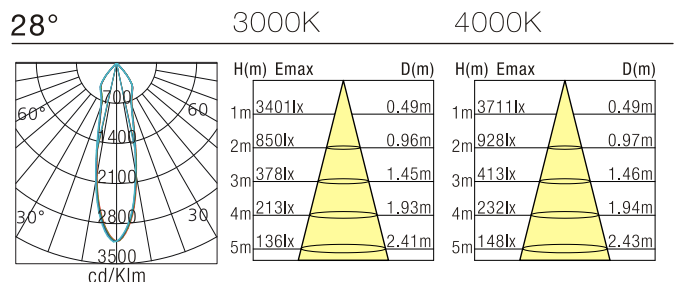
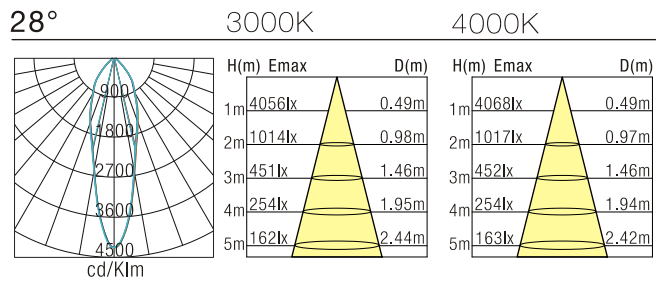
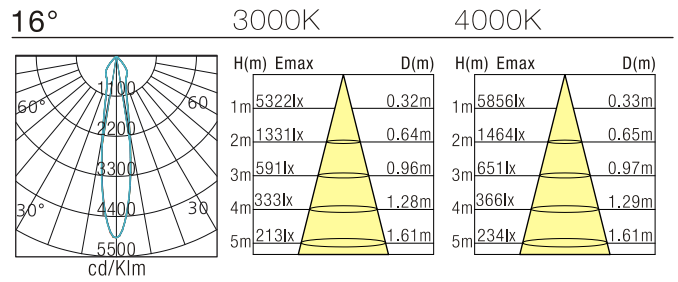
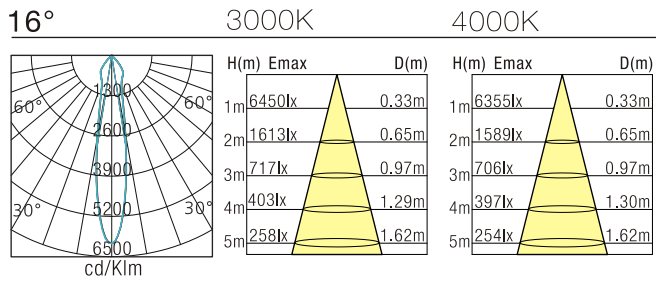

Installation instruction

M04 Module + M01-090-C/S Installation

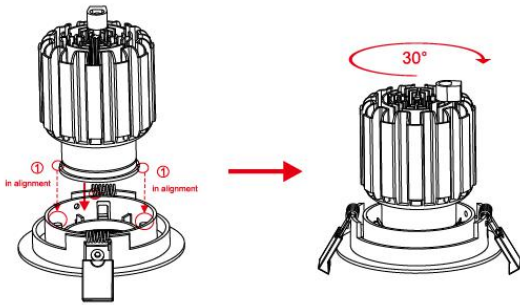

M04 Module + M02-090-C Installation

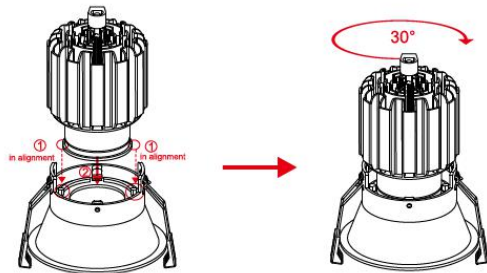

M04 Module + M02-090-S Installation

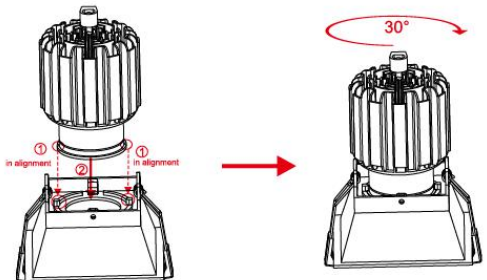

1, Cut Hole



2, Connect Wire

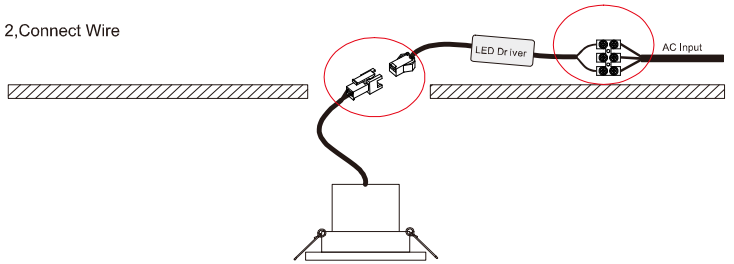

3, Fit the luminaire in the hole

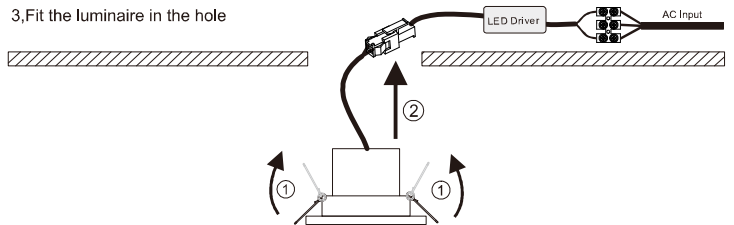

4, Finish

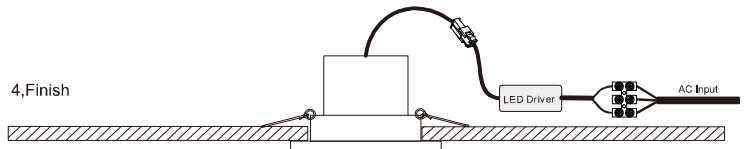

Packaging:

**M041 (Without driver)**

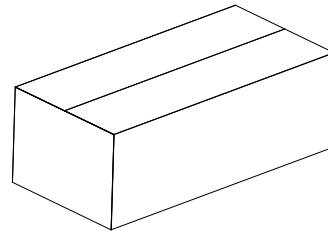
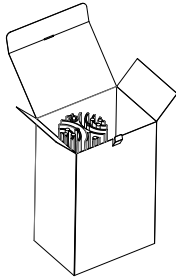

**Box**  
 L105\*W105\*H125mm  
 1pc/box  
 GW: 0.4kg/box

**Outer carton**  
 L430\*W430\*H390mm  
 48pcs/CTN  
 GW: 20.2kg/carton

Product Nomenclature

