

# LED Engine



Halolite Series

## M02-9W

Optical Lens



### Technical Parameters:

Name	Parameters
Light source:	COB
Input Voltage:	AC220~240V 50/60Hz
Current:	200mA
Rated life:	>50,000 hours
Operating temperature:	-20°C~40°C
Storage temperature:	-30°C~60°C
Certificate:	CE/RoHS
Dimmability:	Dimmable Optional
Weight:	0.10KG (M022) / 0.15KG (M0222) 0.19KG (M0223) / 0.20KG (M0224) 0.20KG (M0225) / 0.22KG (M0226)

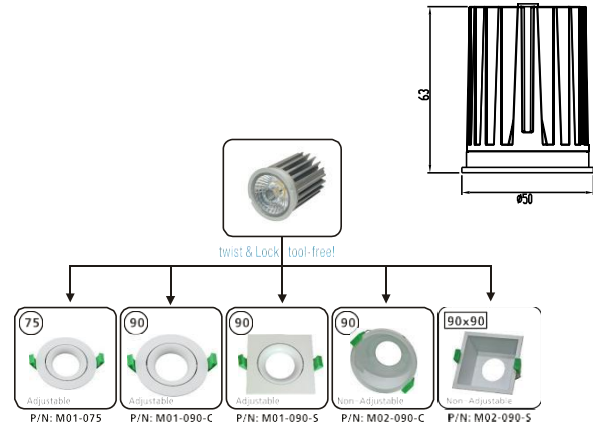

### Ordering Information:

○ Silver gray

Power	CRI	Beam Angle	Luminous	CCT	Housing	Part Number		
9W	82	15°	960 lm	3000K		M022*-9W-830-S-15		
			980 lm	4000K		M022*-9W-840-S-15		
		▲ 24°	950 lm	3000K	○	M022*-9W-830-S-24		
			970 lm	4000K	○	M022*-9W-840-S-24		
		▲ 38°	970 lm	3000K		M022*-9W-830-S-38		
			980 lm	4000K	○	M022*-9W-840-S-38		
		▲ 60°	980 lm	3000K	○	M022*-9W-830-S-60		
			990 lm	4000K		M022*-9W-840-S-60		
		>90		▲ 15°	800 lm	3000K	○	M022*-9W-930-S-15
					890 lm	4000K	○	M022*-9W-940-S-15
				▲ 24°	800 lm	3000K	○	M022*-9W-930-S-24
					880 lm	4000K	○	M022*-9W-940-S-24
				▲ 38°	800 lm	3000K		M022*-9W-930-S-38
					890 lm	4000K		M022*-9W-940-S-38
▲ 60°	810 lm			3000K	○	M022*-9W-930-S-60		
	890 lm			4000K	○	M022*-9W-940-S-60		

\*\*": 1: S-MR16; 2: M01-075; 3: M01-090-C; 4: M01-090-S; 5: M02-090-C; 6: M02-090-S



CRI90 15°

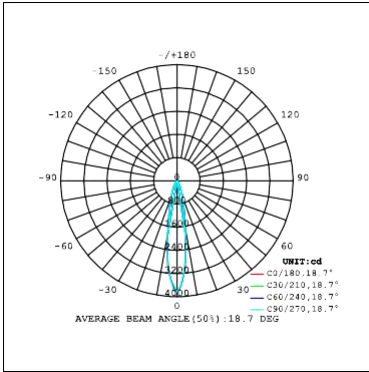

3000K

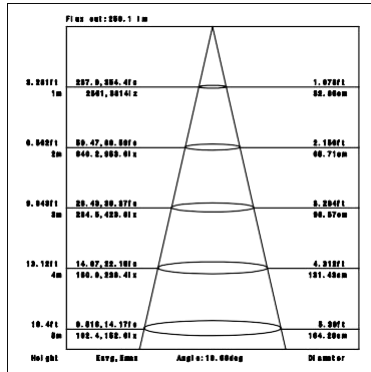

4000K

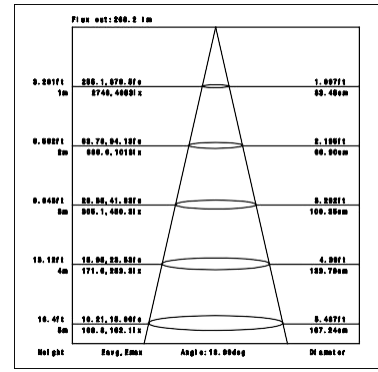

CRI90 24°

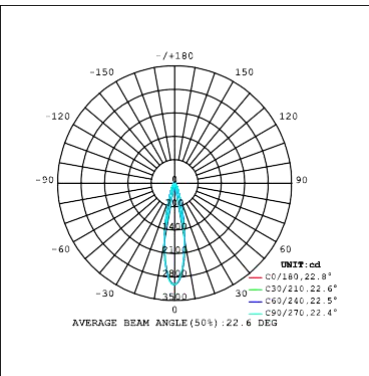

3000K

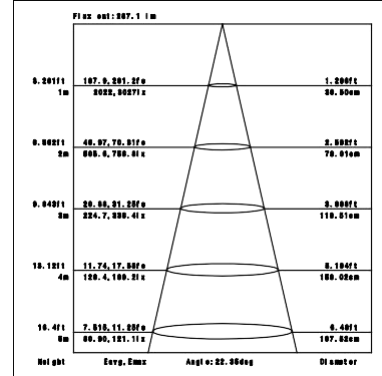

4000K

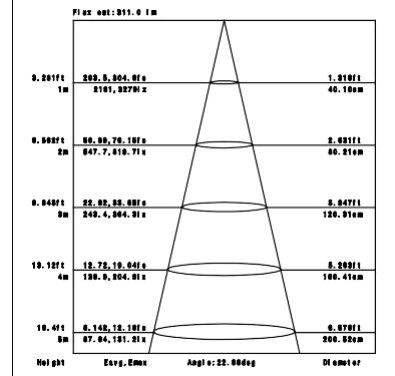

CRI90 38°

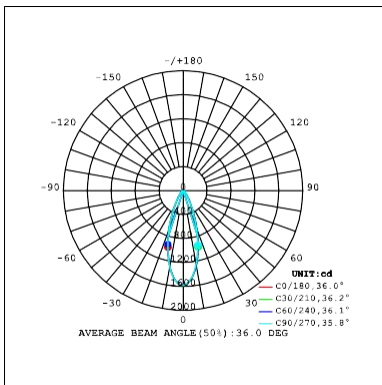

3000K

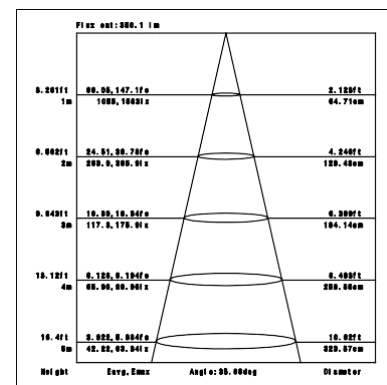

4000K

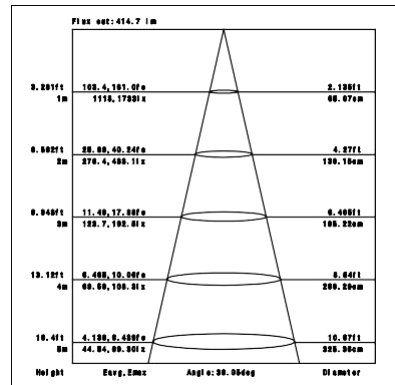

CRI90 60°

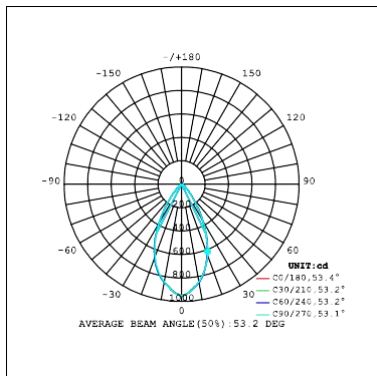

3000K

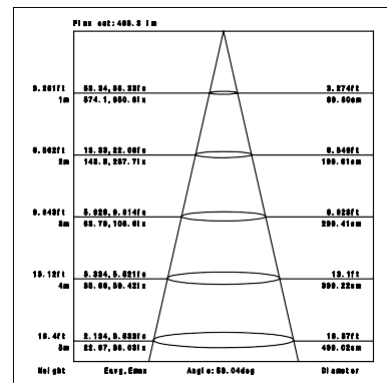

4000K

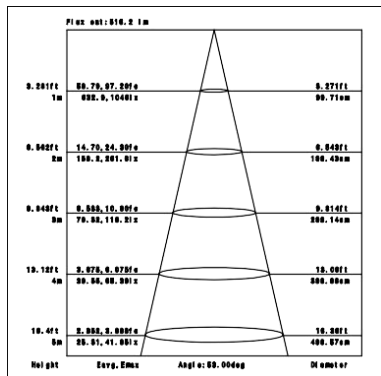

Installation instruction

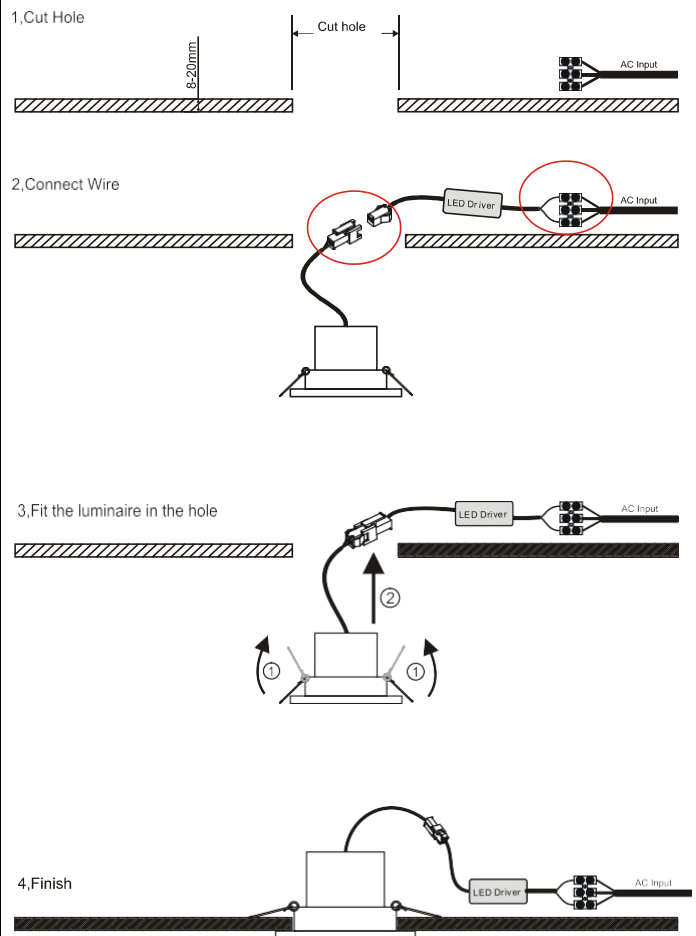
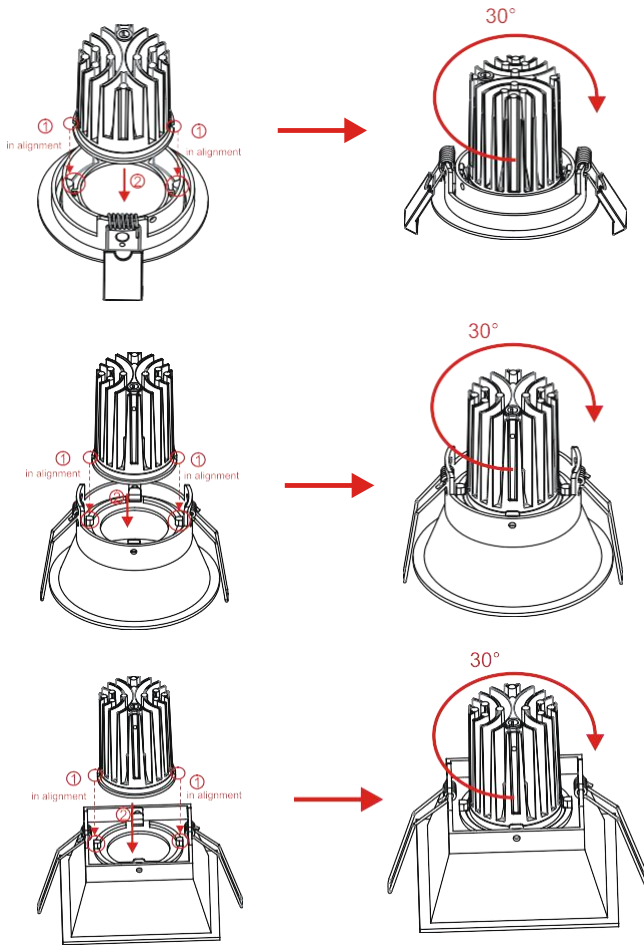

Packaging:

**M012 (Without driver)**

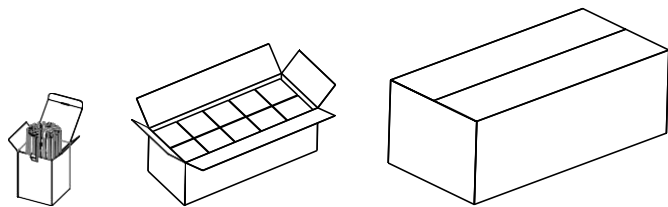

<b>Box</b> L52*W52*H76mm 1pc/box GW: 0.1kg/box	<b>Inner box</b> L270*W110*H95mm 10pc/box GW: 1.05kg/box	<b>Outer carton</b> L600*W300*H230mm 100pcs/CTN GW: 11.5kg/carton
---	---	--

**M012 (With driver)**

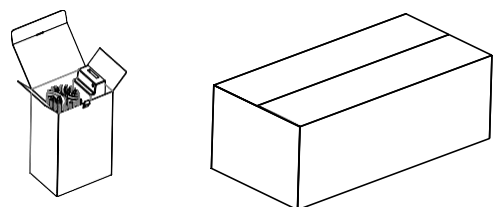

<b>Box</b> L96*W65*H140mm 1pc/box GW: 0.15kg/box	<b>Outer carton</b> L600*W300*H230mm 36pcs/CTN GW: 6.5kg/carton
---	--

**M0122**

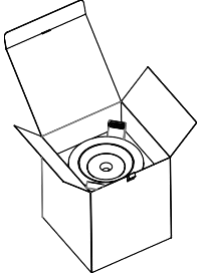

**Box**  
 L105\*W105\*H130mm  
 1pc/box  
 GW: 0.25kg/box

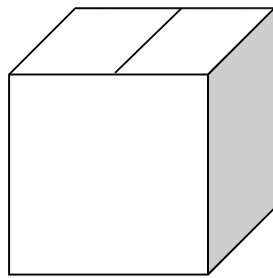

**Outer carton**  
 L450\*W450\*H410mm  
 48pcs/CTN  
 GW: 14kg/carton

**M0123**

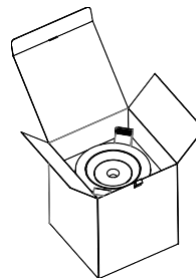

**Box**  
 L105\*W105\*H130mm  
 1pc/box  
 GW: 0.3kg/box

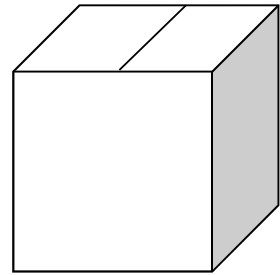

**Outer carton**  
 L450\*W450\*H410mm  
 48pcs/CTN  
 GW: 16kg/carton

**M0124/M0126**

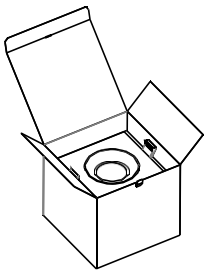

**Box**  
 L130\*W130\*H120mm  
 1pc/box  
 GW: 0.35kg/box

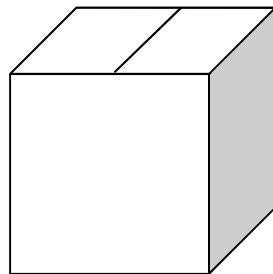

**Outer carton**  
 L540\*W420\*H280mm  
 24pcs/CTN  
 GW: 9.5kg/carton

**M0125**

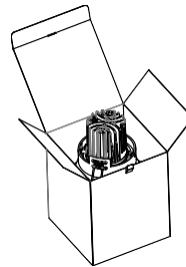

**Box**  
 L105\*W105\*H130mm  
 1pc/box  
 GW: 0.3kg/box

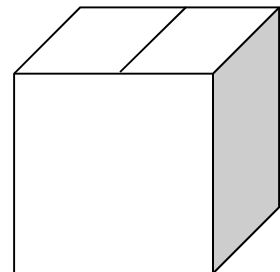

**Outer carton**  
 L450\*W450\*H410mm  
 48pcs/CTN  
 GW: 16kg/carton

Product naming system

